

FENDER FIXED TO THE STAND

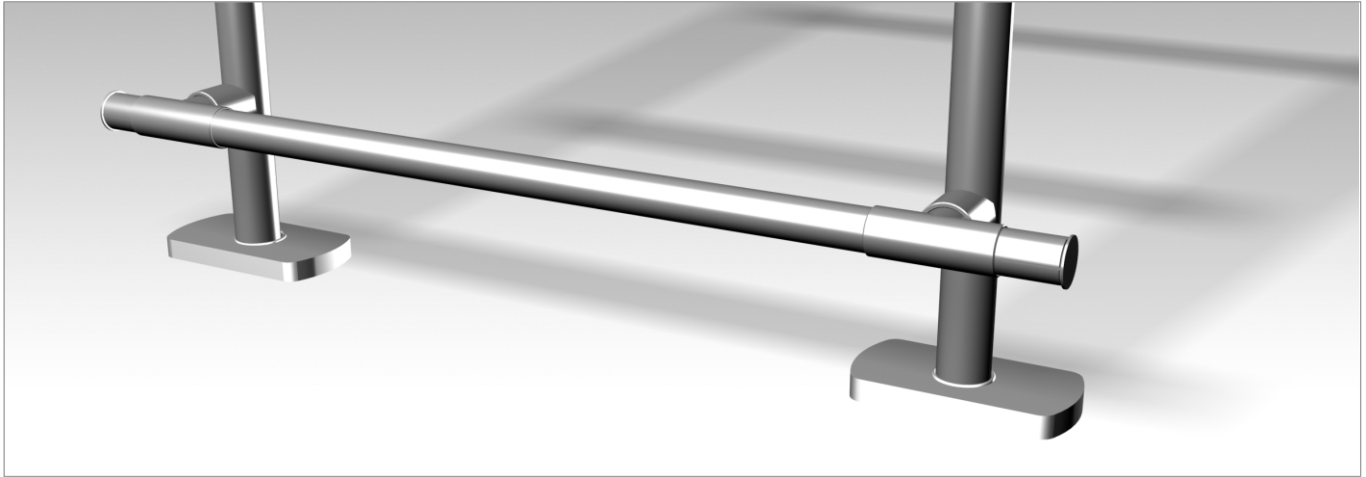
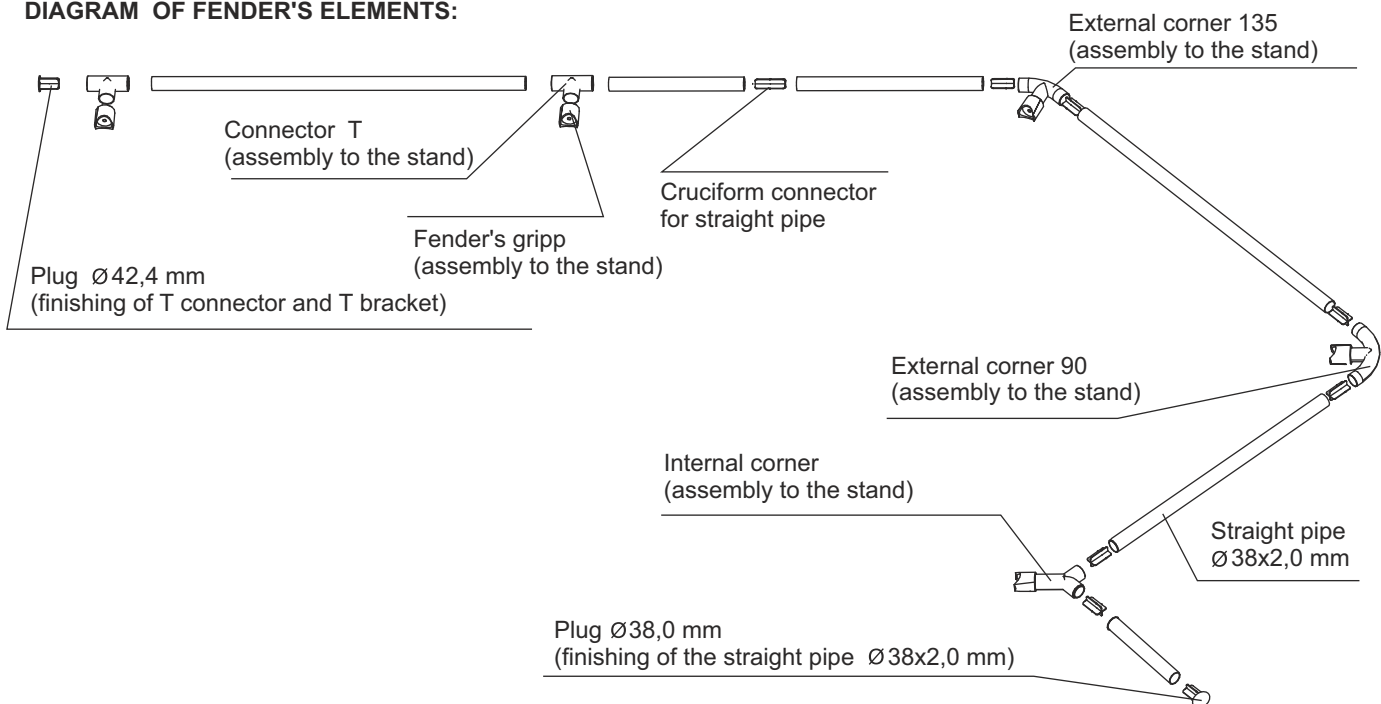

DIAGRAM OF FENDER'S ELEMENTS:



ELEMENTS OF THE FENDER FIXED TO THE STAND:	FINISH	INDEX
Connector T (assembly to the stand)	material - stainless steel	919-380-677
Internal corner (assembly to the stand)	material - stainless steel	—
External corner 135 (assembly to the stand)	material - stainless steel	—
External corner 90 (assembly to the stand)	material - stainless steel	—
Fender's gripp(assembly to the stand)	chrome	919-320-542
Cruciform connector for straight pipe	material - stainless steel	919-380-678
Plug $\varnothing 42,4$ mm (finishing of T connector and T bracket)	material - stainless steel	—
Plug $\varnothing 38,0$ mm (finishing of the straight pipe $\varnothing 38 \times 2,0$ mm)	material - stainless steel	919-380-681
Straight pipe $\varnothing 38 \times 2,0$ mm	material - stainless steel	R_A2_38x2,0-SZ320

S CUSTOMER GUIDANCE SYSTEMS